

# Glow.worm



## The **Flexicom** Range

of high efficiency condensing boilers

# Glow-worm

OFFERING YOU A FULL SYSTEM SOLUTION



With over 75 years of experience in providing UK homes with value for money heating and hot water solutions, Glow-worm has built a reputation on providing straightforward and reliable systems you can depend on.

Today, our heating systems cover not just domestic gas boilers, but renewable technologies, domestic controls and hot water cylinders.

We hope this brochure gives you all the information needed to help you take the next stage in selecting your new Glow-worm heating and hot water system. Should you wish to discuss any area in more detail or if you need any further information, please contact us to see how we can help.

To replace an old boiler or install a new one with the minimum of fuss, you need a boiler that will fit just about anywhere; that's why Glow-worm created the Flexicom.

The Flexicom has a direct rear flue and is so compact it fits inside a standard kitchen cupboard. The Flexicom gives you loads of siting flexibility, particularly useful when replacing an old boiler with an existing direct rear flue, or if space is a premium.

The Flexicom provides a quick and simple installation thanks to a drop down electrical connection block, pre-fixing jig and upward piping frame.

Available as a Combi, Open Vent or Sealed System boiler with a wide range of outputs, the Flexicom is recommended by the Energy Saving Trust with a SEDBUK A and NOx class 5 rating.

# Contents

FLEXICOM RANGE



## Contents

### Flexicom Range:

Flexicom cx Combination Boilers	4-5
Flexicom hx Open Vent Boilers	6-7
Flexicom sx System Boilers	8-9

Control Options	10-11
-----------------	-------

Cylinders Single & Twin Coil	12
------------------------------	----

Accessories	13
-------------	----

### Flueing Options:

Top Rear	14
----------	----

Top Side	15
----------	----

Rear	16
------	----

Vertical	17-18
----------	-------

Plume Management Kit & Accessories	18
------------------------------------	----

Twin	19-20
------	-------

Control Options Matrix	21
------------------------	----

### Product Specifications:

Flexicom cx	22
-------------	----

Flexicom hx	23
-------------	----

Flexicom sx	24
-------------	----

Cylinders: Single Coil	25
------------------------	----

Cylinders: Twin Coil (as part of Clearly Solar Systems)	25
--	----

### After Sales

Market leading customer care	26
------------------------------	----

Our training courses	27
----------------------	----



Optional Glide Down Timer

The Flexicom cx combination boiler is ideal for small to medium sized homes, from apartments to 3 bed detached properties and offers a flexible installation thanks to its compact kitchen cupboard\* fit size.

Available in 24, 30 & 35kW models, the Flexicom cx provides excellent domestic hot water performance with a 5 second hot water delivery\*\*. It is also recommended by the Energy Saving Trust for energy efficiency being SEDBUK A rated with a NOx class 5 rating - the best possible.

The Flexicom is incredibly easy to install with a pre-fixing jig and 'drop down' electrical connections block, which means you don't have to remove the front case during installation or commissioning.

The onboard diagnostics provide superior serviceability and Glow-worm's unique 'Continua' © electronics allow the Flexicom cx to continue where others may fail due to system faults.

The Flexicom cx's small size and direct rear flue option makes the product an excellent retro fit appliance.

### Glide Down Timer

The Glide Down Timer is easy to use; one simple push and the clock glides in to position, set the time to your requirements and another gentle push hides the clock from view inside the base of the boiler.

The Flexicom clock accessory simply clips in to the Glide Down Casing preventing the need to move the case during installation. Available as an optional extra on all Flexicom cx models, the Glide Down Timer provides the same functionality of an inbuilt electromechanical timer without the need for external controls or extra wiring.

\*Sizes of kitchen cupboards may vary. Please check boiler and cupboard dimensions prior to installations.

\*\*Measured at a tap 1m from the boiler.



## Controls

For full information on Glow-worm controls turn to page 11



Features

- SEDBUK A ●
- 5 second hot water delivery (measured at a tap 1m from the boiler) ●
- Advanced diagnostics ●
- NOx class 5 ●
- Inbuilt frost protection ●
- Pre-fixing jig ●
- Drop down electrical connections ●
- Small case size ●
- Direct rear flue ●
- Fits standard kitchen cupboard ●
- Upward piping kit (optional) ●
- Bottom cover plate ●
- Glide down analogue timer (optional) ●
- Outdoor sensor (optional) ●
- Manometer kit (optional) ●

Max. flue lengths

- Horizontal 8m
- Vertical 8m
- Twin 20m
- Direct rear 0.55m

Min. clearances (mm)

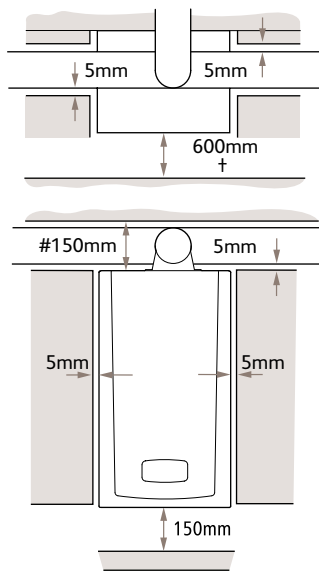

† A removable compartment door can be placed at least 5mm in front of the appliance.

# This can be reduced to 20mm if using a direct rear flue.

Dimensions (mm)

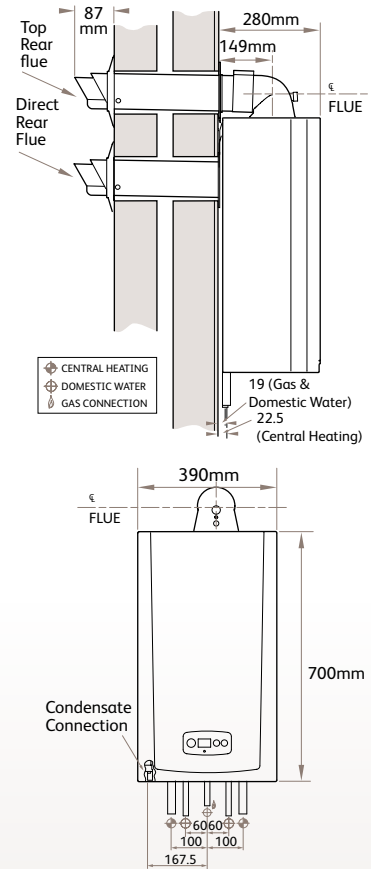

Control options

	Flexicom cx	Climastat	Climapro / Climapro RF	Glide down timer	Outdoor Sensor
<b>To achieve room compensation you will need:</b>					
• Using optional timer	✓	+	✓	+	×
or					
• Using external controls	✓	+	×	✓	×
<b>To achieve weather compensation you will need:</b>					
• Using optional timer	✓	+	✓	+	×
or					
• Using external controls	✓	+	×	✓	+
<b>To achieve basic on/off control you will need:</b>					
• Using optional timer	✓	+	✓	+	×
or					
• Using external controls	✓	+	×	✓	×

Note: Satisfies Part L requirements for time and temperature control when used in the above configurations

Glow-worm has a range of intelligent controls designed to work with the Flexicom cx. The table above shows the various control options available. You will need all the items marked ✓ to achieve the level of control required. For more detailed information see page 10.



The Flexicom hx open vent range is ideal for most homes, from apartments to 5 bedroom detached, the Flexicom hx provides a large supply of hot water through a compact boiler that can fit inside a standard kitchen cupboard\*.

The Flexicom hx is SEDBUK A rated with a NOx class 5 rating, the best possible, and is recommended by the Energy Saving Trust for energy efficiency. Available in 12kW, 15kW, 18kW, 24kW, 30kW and 35kW models, it is compatible with any indirect cylinder and header tank so it's really easy to fit in an existing open vent system.

The Flexicom hx offers a direct rear flue option enabling you to install it just about anywhere. The drop down electrical connections block means that you never have to remove the front case during installation and commissioning.

The onboard diagnostics provide superior serviceability and Glow-worm's unique 'Continua'© electronics allow the Flexicom hx to continue where others may fail due to system faults.

For advanced system efficiencies and greater control, the Flexicom hx can benefit from room and weather compensation when used with Glow-worm's external controls.

\*Sizes of kitchen cupboards may vary. Please check boiler and cupboard dimensions prior to installations.



## Controls & Cylinders



For full information on Glow-worm:  
Controls turn to page 11  
Cylinders turn to page 12



Features

- SEDBUK A ●
- Advanced diagnostics ●
- NOx class 5 ●
- Inbuilt frost protection ●
- Drop down electrical connections ●
- Small case size ●
- Direct rear flue ●
- Fits standard kitchen cupboard ●
- Upward piping kit (optional) ●
- Bottom cover plate ●
- Outdoor sensor (optional) ●  
(Requires Smart Wiring Centre)
- Manometer kit (optional) ●

Min. clearances (mm)

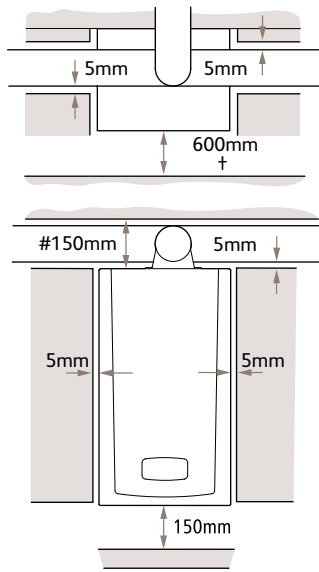

† A removable compartment door can be placed at least 5mm in front of the appliance.

# This can be reduced to 20mm if using a direct rear flue.

Dimensions (mm)

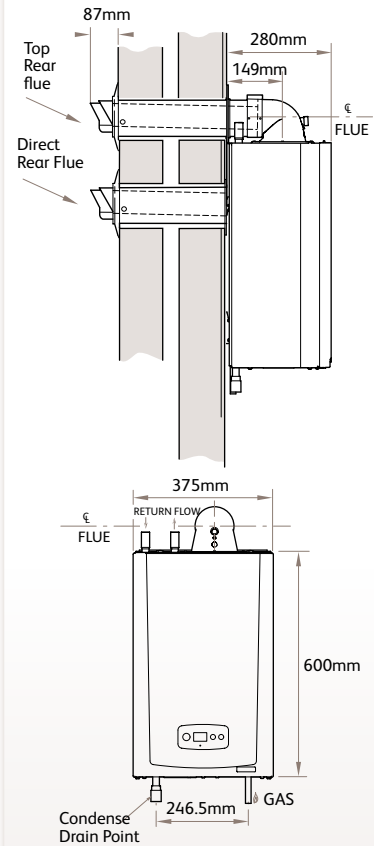

Max. flue lengths

- Horizontal 8m
- Vertical 8m
- Twin 20m
- Direct rear 0.55m

Control options

	Flexicom hx	Climastat	Climapro / Climapro RF	Smart Wiring Centre	Outdoor Sensor
<b>To achieve room compensation you will need:</b>					
• Using external controls	✓	+	×	✓	×
<b>To achieve weather compensation you will need:</b>					
• Using external controls	✓	+	×	✓	+
<b>To achieve basic on/off control you will need:</b>					
• Using external controls	✓	+	×	✓	×

Note: Satisfies Part L requirements for time and temperature control when used in the above configurations

Glow-worm has a range of intelligent controls designed to work with the Flexicom hx. The table above shows the various control options available. You will need all the items marked ✓ to achieve the level of control required. For more detailed information see page 10.



The Flexicom sx system boiler is ideal for most homes, from apartments to 4 bedroom detached, providing superior heating performance together with the power to heat water stored within a cylinder as part of a sealed system, all through a compact boiler that can fit inside a standard kitchen cupboard\*.

Available in 18kW and 30kW models, the Flexicom sx is compatible with any indirect cylinder in an existing sealed system. It is also SEDBUK A rated with a NOx class 5 rating, the best possible and recommended by the Energy Saving Trust for energy efficiency.

The Flexicom sx offers a direct rear flue option meaning you can install it just about anywhere, and the drop down electrical connections block means that you never have to remove the front case during installation and commissioning.

The onboard diagnostics provide superior serviceability and Glow-worm's unique 'Continua'© electronics allow the Flexicom sx to continue where others may fail due to system faults.

For advanced system efficiencies and greater control, the Flexicom hx can benefit from room and weather compensation when used with Glow-worm's external controls.

\*Sizes of kitchen cupboards may vary. Please check boiler and cupboard dimensions prior to installations.



## Controls & Cylinders



For full information on Glow-worm:  
Controls turn to page 11  
Cylinders turn to page 12



Features

- SEDBUK A ●
- Advanced diagnostics ●
- NOx class 5 ●
- Inbuilt frost protection ●
- Pre-fixing jig ●
- Drop down electrical connections ●
- Small case size ●
- Direct rear flue ●
- Fits standard kitchen cupboard ●
- Upward piping kit (optional) ●
- Bottom cover plate ●
- Outdoor sensor (optional) ●  
(Requires Smart Wiring Centre)
- Manometer kit (optional) ●

Min. clearances (mm)

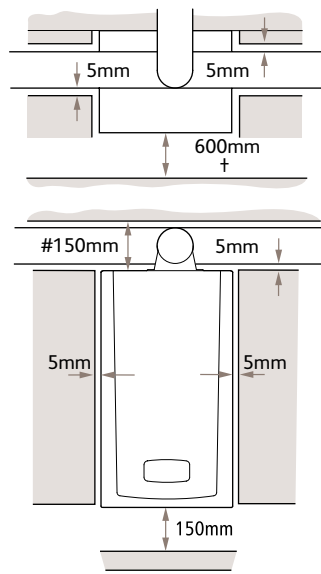

† A removable compartment door can be placed at least 5mm in front of the appliance.

# This can be reduced to 20mm if using a direct rear flue.

Dimensions (mm)

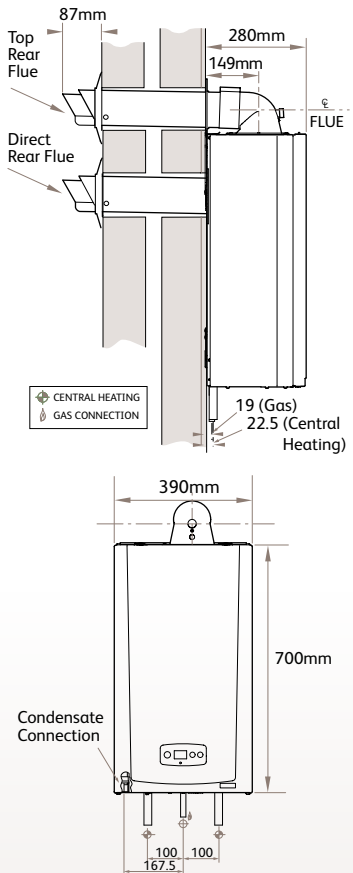

Max. flue lengths

- Horizontal 8m
- Vertical 8m
- Twin 20m
- Direct rear 0.55m

Control options

	Flexicom sx	Climastat	Climapro/ Climapro RF	Smart Wiring Centre	Outdoor Sensor
<b>To achieve room compensation you will need:</b>					
• Using external controls	✓	+	x	✓	x
<b>To achieve weather compensation you will need:</b>					
• Using external controls	✓	+	x	✓	+
<b>To achieve basic on/off control you will need:</b>					
• Using external controls	✓	+	x	✓	x

Note: Satisfies Part L requirements for time and temperature control when used in the above configurations

Glow-worm has a range of intelligent controls designed to work with the Flexicom sx. The table above shows the various control options available. You will need all the items marked ✓ to achieve the level of control required. For more detailed information see page 10.



Glow-worm believes that when it comes to heating the home efficiently, choosing the right controls is almost as important as choosing the right boiler. Not only will the right control keep the home at the right temperature, but will also help to save money and conserve the environment through preventing unnecessary boiler activity.

Glow-worm's range of intelligent controls are specifically designed to work with Glow-worm appliances creating highly efficient heating systems and greater home comfort. The Climastat, Climapro and Climapro RF are fully compatible with the Flexicom range.

The Climastat is a room thermostat which controls temperature and the Climapro and Climapro RF are programmable room thermostats which have two channels enabling your customer to have timed hot water and central heating.

The Climapro RF has exactly the same functionality as the Climapro, except it talks to the Flexicom using radio frequency (RF) technology.

### Intelligent Room Control Explained

Intelligent room control is a simple method of controlling the flow temperature of water to the central heating system based on the temperature measured in the room. As the temperature in the room approaches the desired set point, the Climastat or Climapro/RF begins to lower the flow temperature of water

supplied to the central heating system (radiators). A lower flow temperature means that the boiler operates more efficiently in, or closer to the condensing mode. Energy costs are then reduced and a more stable and comfortable room temperature is achieved.

### Weather Compensation Explained

Weather compensation measures the temperature outside the property and adjusts the flow temperature to the radiators accordingly. The colder the outdoor temperature, the hotter the flow temperature, and conversely the warmer the outdoor temperature the cooler the flow temperature will be. The effect is that the flow temperature adjusts the output of the radiators to meet the actual heat demand of the property. The lower flow temperature also ensures that the boiler operates more efficiently.

### Smart Wiring Centre

This intelligent functionality can be achieved on the Flexicom hx and sx with Glow-worm controls by installing a Smart Wiring Centre available from Glow-worm as an accessory.

**When the Climastat and Climapro/RF are used for room (load) or weather compensators, an additional 2% points can be added to the boilers SEDBUK value as used in the Code for Sustainable Homes.**

The Glow-worm range of controls can be combined with the complete Flexicom range to achieve room compensation, weather compensation or simple on/off functionality. See page 21 for full details.



## Climastat

**Room thermostat - temperature only**

- Extra low voltage
- Simple & discreet 2 wire connection
- Polarity not important
- Easy to use



## Climapro

**Room thermostat - programmable room thermostat time and temperature**

- 2 channel controller for central heating and hot water
- Provides 24 hour or 7 day timed programme options
- Extra low voltage
- Simple & discreet 2 wire connection
- Polarity not important
- Easy to use



## Climapro RF

**Room thermostat - wireless programmable room thermostat time and temperature**

- Wireless
- Works with RF receiver connected to the boiler
- 2 channel controller for central heating and hot water
- Provides 24 hour or 7 day timed programme options
- Extra low voltage
- Polarity not important
- Easy to use



# Cylinders

SINGLE AND TWIN COIL



## Single coil cylinders

Manufactured from high grade stainless steel with laser welded seams, Glow-worm cylinders are extremely reliable, hard wearing and come complete with a 25 year warranty against perforation of the steel shell. Built with efficiency and performance in mind, our cylinders incorporate excellent insulation that achieves heat loss as low as 1.7kWh/24hrs and a high recovery heating coil that reheats the cylinder in as little as 20 minutes\*.

Available in six sizes 115, 150, 175, 200, 250 and 300 litres, Glow-worm cylinders are suitable for all sizes of property from small single bathroom apartments up to a larger three bedroom property with en-suite shower room.

## Twin coil cylinders

Unvented, stainless steel and narrow enough to fit through any standard airing cupboard door, the Glow-worm twin coil cylinder is the perfect choice for the home which is considering solar thermal now or in the future. Fully compatible with any open vent or sealed system boiler, the Twin coil cylinder performs in the same way as a single coil cylinder but with the added flexibility of being solar ready.

Special construction of the coils inside the cylinder ensures that the top 2/3 of the cylinder is heated first enabling high volumes of hot water to be delivered on demand.

In situations when the twin coil cylinder is installed with a Glow-worm Clearly Solar system, the cylinder benefits from a thermostatic mixing valve which mixes cold water into the solar heated water to achieve the required temperature for safe water usage.

For more information on Clearly Solar please visit:  
[www.glow-worm.co.uk](http://www.glow-worm.co.uk)

## Main features

- High grade stainless steel cylinder with laser welded seams
- Single coil available in 115, 150, 175, 200, 250 & 300 litres
- Twin coil available in 200, 250 & 300 litres
- Insulation meets CheSS best practice as low as 1.7kWh/24hrs (single coil cylinder) \*
- High recovery heating coil - just 20 minutes
- External expansion vessel (supplied)
- Covered controls and wiring box
- Simple maintenance - no anode required
- High flow rates achievable working at 3.5bar pressure
- 25 year warranty in cylinder shell
- Safety temperature devices help to achieve a quick & easy installation

\* Attainable with the 115 Litre model

# Accessories

PLUME & CONDENSATE SOLUTIONS

## Plume Management Kit

To resolve the problems that plume can cause when a condensing boiler is running, Glow-worm has created the Plume Management Kit; a clever accessory which allows the plume to be exhausted further away from the duct, reducing the visual impact of the vapour trail.

The simple piping kit fits neatly onto the horizontal flue of any Glow-worm high efficiency boiler and can be extended up to a maximum of 6m\* in length, fitting easily round ledges and other obstacles to achieve minimum clearance levels required on installations.

\* Maximum flue lengths must not be exceeded

### Kit features

- Compatible with all Glow-worm high efficiency boilers
- Can be retro-fitted to any existing Glow-worm Flexicom installation
- Additional elbows, bends and 1-metre extensions available
- Simple push-fit connection
- Available in black or white to match rain water fittings

## Plume Deflector Kit

Compatible with all Glow-worm high efficiency boilers, the Plume Deflector Kit is a useful accessory designed to take the hassle out of flue gas termination by diverting plume left, right or upwards away from problem zones such as adjacent properties or walk ways. Available in black or white, the Plume Deflector Kit can be installed quickly and simply onto a horizontal flue instead of the standard terminal end piece during or after installation.



## Condensate Pump

To remove the problems associated in locating a suitable outlet to draining away waste from the condensing boiler, Glow-worm have produced a condensate pump that can collect the condensate from the boiler and pump it back into the waste system aiding a more flexible installation.



Glow-worm's Condensate Pump is the smallest available in the UK and operates at maximum efficiency with the reservoir



Glow-worm Plume Management kit

pump discharging the condensate in one go when the fill level is reached, rather than as a continuous operation.

The Condensate Pump is extremely reliable; in the unlikely event of it becoming too full, the overflow safety switch will automatically shut the connected boiler down and the pump's LED display will flash red indicating a fault ensuring the pump is completely safe to use and will display a fault code on the boiler.

### Pump features

- One of the smallest condensate pumps in the UK
- Compatible with all Glow-worm Flexicom models
- Vertical pump height up to 4m
- 6m discharge hose for connecting the pump to the waste water system
- Over flow safety switch

## Ridge Tile Terminal

Designed for use on all Glow-worm high efficiency boilers, the ridge tile terminal accessory is designed to make the roof finish look neater and less obtrusive. Available in a black enamel finish, the ridge tile terminal fits with specified ridge tiles from an approved manufacturer. Please contact Glow-worm for further information.



# Flueing horizontal

OPTIONS & ACCESSORIES

## Flue options : top rear

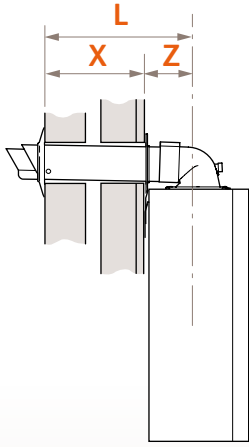

### Horizontal Flue Options: Top Rear

**L** = Flue length, measured from outside wall face to centre line of flue outlet.

If **L** is less than 584mm then only the horizontal flue is required.

If **L** is greater than 584mm then extensions are required.

If **L** is less than 379mm then use horizontal top flue A2043400, which can be cut to suit a minimum wall thickness of 75mm.

**X** = wall thickness.

**Z** = distance from centre line of flue outlet to inside wall face.

The horizontal flue can be extended by up to 8m.

The maximum flue length with extensions must not be exceeded (refer to **L** in table below).

For each additional 90° or 2 x 45° bends fitted, the maximum flue length must be reduced by 1m.

The vertical flue adaptor **G** is required for vertical flue connections to the boiler.

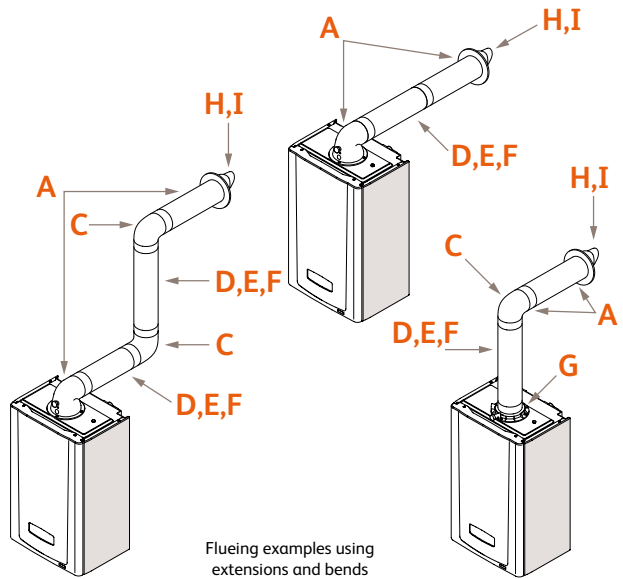

## Flue options : top rear

A	Model	L Max. with Ext. (m)	X (mm)		Z (mm)	A Horizontal Telescopic flue
			Min	Max		
	24cx 30cx 35cx	8.0	230	435	149	
	12hx 15hx 18hx 24hx 30hx 35hx	8.0	230	435	149	
	18sx 30sx	8.0	230	435	149	

## Flue accessories : top rear

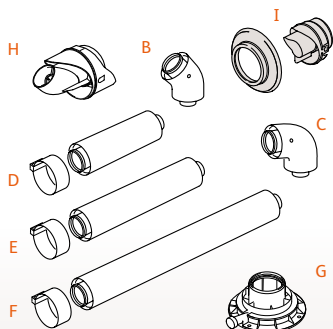

<b>B</b>	<b>C</b>	<b>D</b>	<b>E</b>
45° Bend 2000460485 (2 off)	90° Bend 2000460484 (1 off)	0.5m Extension 2000460481 (1 off)	1m Extension 2000460482 (1 off)
<b>F</b>	<b>G</b>	<b>H</b>	<b>I</b>
2m Extension 2000460483 (1 off)	Vertical Flue Adaptor A2024600	Deflector Terminal Black 0020060582 White 0020060583	Black Terminal A2043700

Flue options : top side

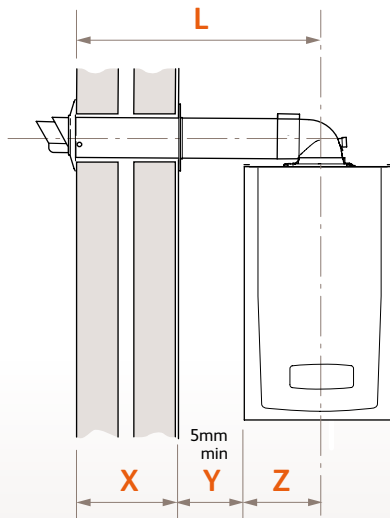

Horizontal Flue Options: Top Side

L = Flue length, measured from outside wall face to centre line of flue outlet.

If L is less than 584mm then only the horizontal flue is required.

If L is greater than 584mm then extensions are required.

If L is less than 379mm then use horizontal top flue A2043400, which can be cut to suit a minimum wall thickness of 75mm.

X = wall thickness.

Y = distance from the side of the boiler to the inside wall face.

Z = distance from centre line of flue outlet to side of boiler.

The horizontal flue can be extended by up to 8m.

The maximum flue length with extensions must not be exceeded (refer to L in table below).

For each additional 90° or 2 x 45° bends fitted, the maximum flue length must be reduced by 1m.

The vertical flue adaptor G is required for vertical flue connections to the boiler.

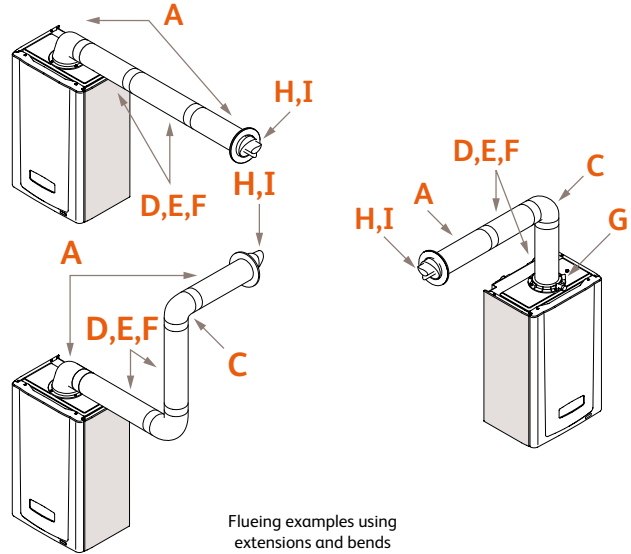

Flueing examples using extensions and bends

Flue options : top side

A	Model	L Max. with Ext. (m)	X (mm)		Z (mm)	A	A Horizontal Telescopic flue
			Min	Max			
	24cx 30cx 35cx	8.0	154	359	220	left	
			204	409	170	right	
	12hx 15hx 18hx 24hx 30hx 35hx	8.0	156.5	361.5	217.5	left	
			216.5	421.5	157.5	right	
	18sx 30sx	8.0	154	359	220	left	
			204	409	170	right	

A2043600

Flue accessories : top side

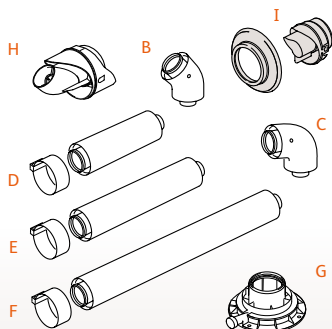

B	C	D	E
45° Bend 2000460485 (2 off)	90° Bend 2000460484 (1 off)	0.5m Extension 2000460481 (1 off)	1m Extension 2000460482 (1 off)
F	G	H	I
2m Extension 2000460483 (1 off)	Vertical Flue Adaptor A2024600	Deflector Terminal Black 0020060582 White 0020060583	Black Terminal A2043700

## Flue options : rear

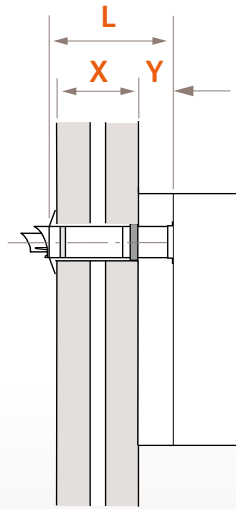

### Horizontal Flue Options: Rear

**L** = Flue length, measured from the rear of the boiler to outside wall face.

**X** = Wall thickness.

**Y** = 28mm

The maximum flue length with extensions must not be exceeded (refer to **L** in table below).

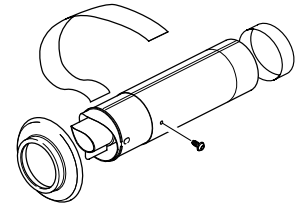
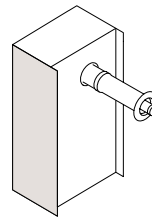

Flueing example using rear flue A2043500

## Flue options : rear

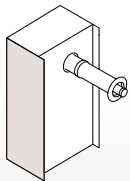

Model	L Max. (mm)	X (mm)		Description of Part	A Horizontal Telescopic flue
		Min	Max		
24cx 30cx 35cx	550	75	512	Rear Flue	
12hx 15hx 18hx 24hx 30hx 35hx	550	75	512	Rear Flue	
18sx 30sx	550	75	512	Rear Flue	

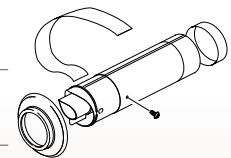

A2043500

# Flueing vertical

OPTIONS & ACCESSORIES

## Flue options : vertical

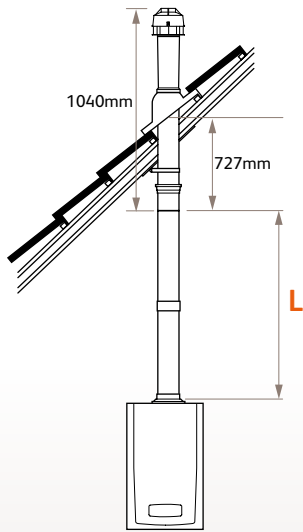

## Vertical Flue Options

**L** = Flue length, measured from the top of the boiler up to the flue terminal underside of the roof flashing.

Maximum flue length is 10m plus vertical roof terminal.

The maximum flue length must not be exceeded (refer to **L** in table below).

For each 90° or 2 x 45° bends fitted the maximum flue length must be reduced by 1m.

Vertical flue options use the same 100mm diameter flue components as the horizontal flue options.

The vertical flue adaptor **G** is required for vertical flue connections to the boiler.

Horizontal sections must have a continuous fall of at least 2.5° (44mm/metre) back to the boiler.

## Flue options : vertical

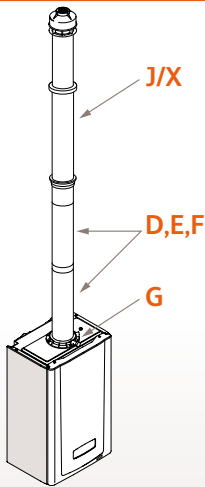

Model	L Max. with Ext. (m)	Description of Parts	Part Number
All Models	8.0	<b>D</b> 0.5m Extension (1 off) or	2000460481
All Models	8.0	<b>E</b> 1m Extension (1 off) or	2000460482
All Models	8.0	<b>F</b> 2m Extension (1 off)	2000460483
All Models	8.0	<b>G</b> Vertical Flue Adaptor	A2024600
All Models	8.0	<b>J</b> Vertical Roof Terminal	2000460480

## Flue accessories : vertical

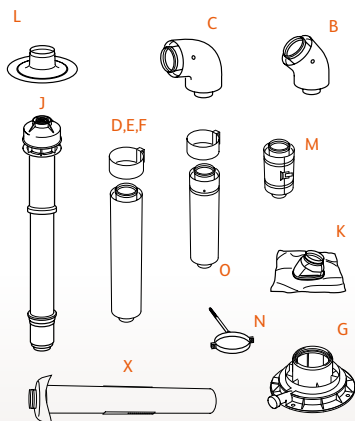

B	C	D	E	F
45° Bend 2000460485 (2 off)	90° Bend 2000460484	0.5m Extension 2000460481 (1 off)	1m Extension 2000460482 (1 off)	2m Extension 2000460483 (1 off)
<b>G</b>	<b>J</b>	<b>K</b>	<b>L</b>	<b>M</b>
Vertical Flue Adaptor A2024600	Vertical Roof Terminal 2000460480	Pitched Roof Flashing 2000460479	Flat Roof Flashing 2000460478	Sliding Sleeve 2000460487
<b>N</b>	<b>O</b>	<b>X</b>		
Fixing Bracket 2000460486 (5 off)	Telescopic Extension A2036900	Ridge Tile Terminal A2043800		

# Flueing vertical

OPTIONS & ACCESSORIES

Flueing examples using extensions and bends

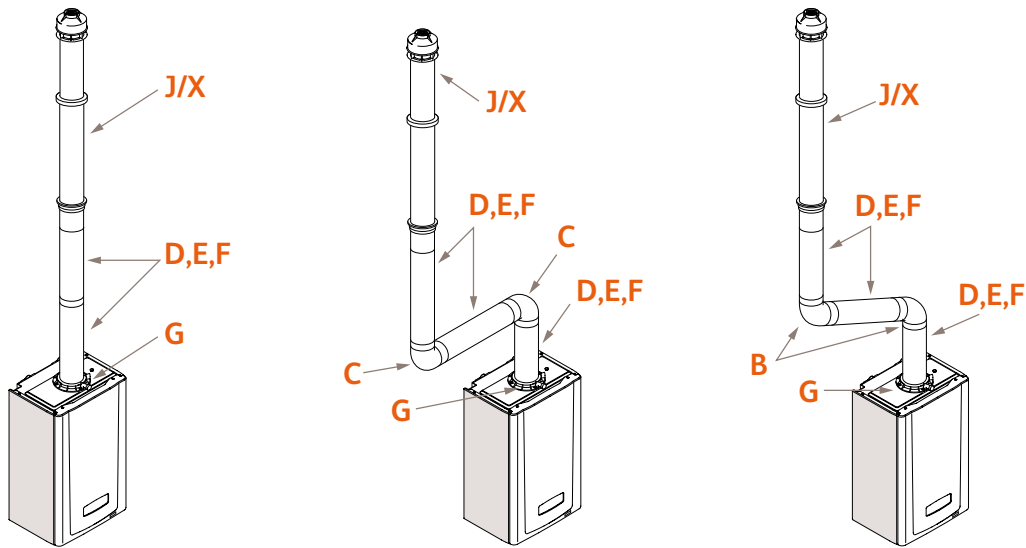

## Plume Management Kit

The Plume Management Kit fits onto the horizontal flue and allows the flue outlet to be raised by up to 6m. This ensures that the flue gases are vented at a higher level.

The maximum permitted flue length (P) is measured from the centre line of the flue terminal to the top of the outlet terminal. Maximum flue length (P) must not exceed 6m and be added to the maximum flue length calculation.

For each additional 90° or 2 x 45° bends fitted, the maximum length must be reduced by 1m.

## Telescopic flue

Horizontal Telescopic Flue  
A2043600

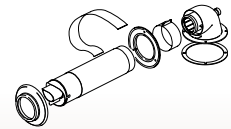

## Plume management kit

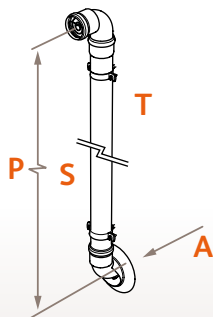

Model	P (mm)	
	Min	Max
All Models	500	6000

Black: A2044000 / White A2044100

T Plume Management Kit

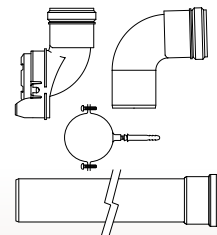

## Accessories

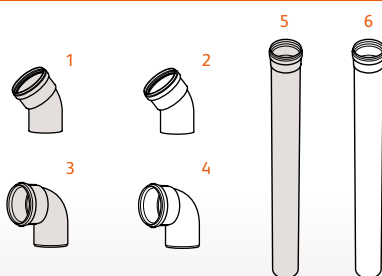

1	2	3
45° Bend Black A2044400 (2 off)	45° Bend White A2044500 (2 off)	90° Bend Black A2044600
4	5	6
90° Bend White A2044700	1m Extension Black A2044200	1m Extension White A2044300

# Flueing twin

OPTIONS & ACCESSORIES

## Flue options : twin

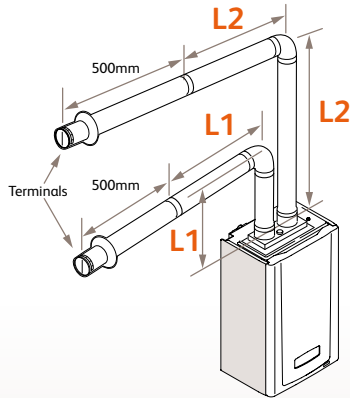

## Twin Flue Options

**L = L1+ L2** Maximum available combined flue length (**L1** air inlet and **L2** flue outlet), measured from top of boiler (not including terminals).

Maximum flue length is 20m (**L1+ L2**) plus terminals.

For each 90° or 2 x 45° bends fitted the maximum flue length must be reduced by 1m.

Air inlet and flue outlet terminals must be installed so that they are exposed to external air.

The flue outlet must be above the air inlet if mounted vertically. Horizontal sections must have a continuous fall of at least 2.5° (44mm/metre) back to the boiler.

The minimum distance between flue and air terminals is 300mm (between terminal centres).

## Twin flue adaptor

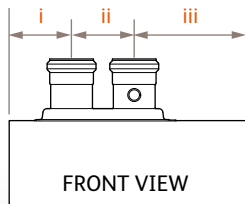

P Twin Flue adaptor A2011000

Model	i (mm)	ii (mm)	iii (mm)
24cx 30cx 35cx	100	120	170
12hx 15hx 18hx 24hx 30hx 35hx	97.5	120	157.5
18sx 30sx	100	120	170

## Twin flue option 1

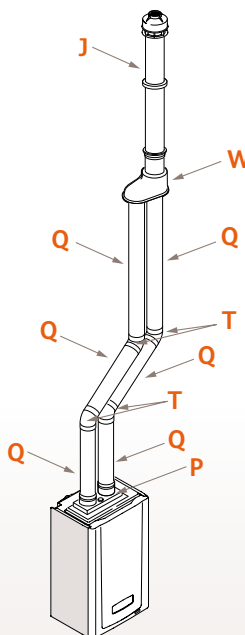

Model	L = L1 air + L2 flue (m) Max Combined Flue Length	Description of Parts	Part Number
All Models	20	J Vertical Roof Terminal	2000460480
All Models	20	P Twin Flue Adaptor	A2011000
All Models	20	Q 1m Extension (1 off)	A2011100
All Models	20	T 45° Bend (2 off)	A2011300
All Models	20	W Twin Pipe to Concentric Adaptor	A2011600

# Flueing twin

OPTIONS & ACCESSORIES

## Twin flue option 2

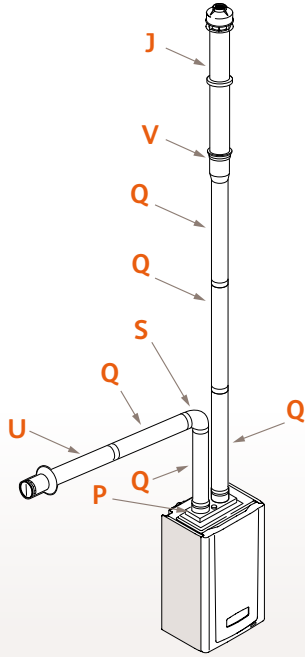

Model	L = L1 air + L2 flue (m) Max Combined Flue Length	Description of Parts	Part Number
All Models	20	J Vertical Roof Terminal	2000460480
All Models	20	P Twin Flue Adaptor	A2011000
All Models	20	Q 1m Extension (1 off)	A2011100
All Models	20	S 90° Bend (1 off)	A2011400
All Models	20	U Horizontal Terminal	A2011200
All Models	20	V Single Pipe Adaptor	A2011500

## Twin flue option 3

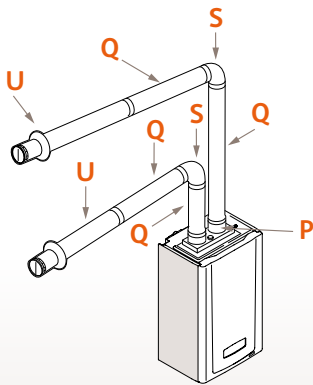

Model	L = L1 air + L2 flue (m) Max Combined Flue Length	Description of Parts	Part Number
All Models	20	P Twin Flue Adaptor	A2011000
All Models	20	Q 1m Extension (1 off)	A2011100
All Models	20	S 90° Bend (1 off)	A2011400
All Models	20	U Horizontal Terminal	A2011200

## Twin flue accessories

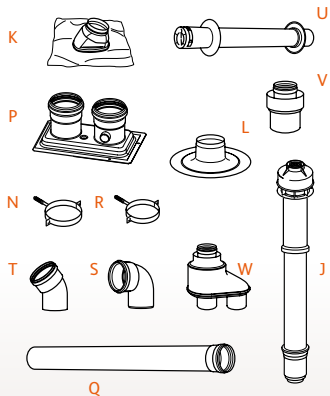

J	K	L	N	P	Q
Vertical Roof Terminal 2000460480	Pitched Roof Flashing 2000460479	Flat Roof Flashing 2000460478	Ø 100mm Fixing Bracket 2000460486 (5 off)	Twin Flue Adaptor A2011000	1m Extension A2011100
R	S	T	U	V	W
Ø 80mm Fixing Bracket A2012800 (5 off)	90° Bend A2011400	45° Bend A2011300 (2 off)	Horizontal Terminal A2011200	Single Pipe Adaptor A2011500	Twin Pipe to Concentric Adaptor A2011600

# Controls options

COMPATIBILITY MATRIX

Control options : cx	Flexicom cx		Climastat		Climapro / Climapro RF		Glide Down Timer		Outdoor Sensor
<b>To achieve room compensation you will need:</b>									
• Using optional timer	✓	+	✓	+	✗		✓		✗
or									
• Using external controls	✓	+	✗		✓		✗		✗
<b>To achieve weather compensation you will need:</b>									
• Using optional timer	✓	+	✓	+	✗		✓	+	✓
or									
• Using external controls	✓	+	✗		✓	+	✗		✓
<b>To achieve basic on/off control you will need:</b>									
• Using optional timer	✓	+	✓	+	✗		✓		✗
or									
• Using external controls	✓	+	✗		✓		✗		✗

Control options : hx/sx	Flexicom hx / sx		Climastat		Climapro / Climapro RF		Smart Wiring Centre		Outdoor Sensor
<b>To achieve room compensation you will need:</b>									
• Using external controls	✓	+	✗		✓	+	✓		✗
<b>To achieve weather compensation you will need:</b>									
• Using external controls	✓	+	✗		✓	+	✓	+	✓
<b>To achieve basic on/off control you will need:</b>									
• Using external controls	✓	+	✗		✓	+	✓		✗

## Specifications : cx

Flexicom :	24cx	30cx	35cx		
<b>Size</b>	Casing dimensions (h w d)(mm)	700 x 390 x 280	700 x 390 x 280	700 x 390 x 280	
	Weight (lift)	36kg	36kg	36kg	
<b>Performance</b>	CH output (kW) Min/Max	9.3/18.0	9.3/24.0	9.3/30.0	
	DHW output (kW) Min/Max	9.3/25.1	9.3/30.0	9.3/35.0	
	CH condensing Max output (kW)	18.8	24.9	31.0	
	DHW flow rate l/min. 35°C rise	9.85	12.3	14.4	
	DHW response*	5 seconds	5 seconds	5 seconds	
	SEDBUK rating	A	A	A	
	SEDBUK %	90.3	90.0	90.2	
	NOx class 5 (natural gas)	Yes	Yes	Yes	
	Adjustable to LPG	No	No	No	
	Main heat exchanger type	Cast	Cast	Cast	
<b>Construction</b>	Heat exchanger material	Aluminium	Aluminium	Aluminium	
	Burner type	Pre-mixed	Pre-mixed	Pre-mixed	
	Fully modulating	Yes	Yes	Yes	
	DHW plate heat exchanger	Yes	Yes	Yes	
	Integrated hydrobloc	Yes	Yes	Yes	
	Suitable for sealed systems	Yes	Yes	Yes	
<b>Installation</b>	Suitable for open-vent systems	No	No	No	
	Filling loop	Integral	Integral	Integral	
	Flow restrictor	Yes 8.7 l/min	Yes 11.7 l/min	Yes 14 l/min	
	Inbuilt system bypass	Yes automatic	Yes automatic	Yes automatic	
	Inbuilt condensate trap/siphon	Yes	Yes	Yes	
	Inbuilt boiler frost protection	Two stage	Two stage	Two stage	
	'Continua' electronics	Yes	Yes	Yes	
	Zero compartment ventilation	Yes	Yes	Yes	
	<b>Clearances</b>	Top (mm) (from top of boiler)	150	150	150
		Side (mm)	5	5	5
Bottom (mm)		150	150	150	
Front (mm)**		600	600	600	
<b>User Interface</b>	User display	2 Digit LCD	2 Digit LCD	2 Digit LCD	
	Diagnostics	Advanced	Advanced	Advanced	
	User adjustable CH temp control	Yes	Yes	Yes	
	User adjustable DHW temp control	Yes	Yes	Yes	
	Optional inbuilt timer	Yes	Yes	Yes	
<b>Pipes</b>	Prefixing jig with DIN layout	Yes	Yes	Yes	
	Optional spacing frame	Yes	Yes	Yes	
	Water connections	2 x 22mm 2 x 15mm	2 x 22mm 2 x 15mm	2 x 22mm 2 x 15mm	
<b>Flues</b>	Max horizontal	8m	8m	8m	
	Max vertical	8m	8m	8m	
	Max twin flue (total air + flue)	20m	20m	20m	
	Max direct rear flue	0.55m	0.55m	0.55m	
	Optional Plume Management Kit	Yes	Yes	Yes	

\* 1 metre from the tap \*\* This can be reduced to 5mm for removable panel

## Specifications : hx

Flexicom :	12hx	15hx	18hx	24hx	30hx	35hx	
Size	Casing dimensions (h w d)(mm)	600 x 375 x 280	600 x 375 x 280	600 x 375 x 280	600 x 375 x 280	600 x 375 x 280	600 x 375 x 280
	Weight (lift)	25kg	25kg	25kg	25kg	25kg	25kg
	CH output (kW) Min/Max	9.3/12.0	9.3/15.0	9.3/18.0	9.3/24.0	9.3/30.0	9.3/35.0
Performance	CH condensing Max output (kW)	12.8	15.8	18.8	24.8	31.0	36.0
	SEDBUK rating	A	A	A	A	A	A
	SEDBUK %	90.7	90.5	90.4	90.3	90.0	90.3
	NOx class 5 (natural gas)	Yes	Yes	Yes	Yes	Yes	Yes
	Adjustable to LPG	No	No	No	No	No	No
Construction	Main heat exchanger type	Cast	Cast	Cast	Cast	Cast	Cast
	Heat exchanger material	Aluminium	Aluminium	Aluminium	Aluminium	Aluminium	Aluminium
	Burner type	Pre-mixed	Pre-mixed	Pre-mixed	Pre-mixed	Pre-mixed	Pre-mixed
	Fully modulating	Yes	Yes	Yes	Yes	Yes	Yes
Installation	Suitable for sealed systems	Yes	Yes	Yes	Yes	Yes	Yes
	Suitable for open-vent systems	Yes	Yes	Yes	Yes	Yes	Yes
	Inbuilt condensate trap/siphon	Yes	Yes	Yes	Yes	Yes	Yes
	Inbuilt boiler frost protection	Two stage	Two stage	Two stage	Two stage	Two stage	Two stage
	'Continua' electronics	Yes	Yes	Yes	Yes	Yes	Yes
Clearances	Zero compartment ventilation	Yes	Yes	Yes	Yes	Yes	Yes
	Top (mm) (from top of boiler)	150	150	150	150	150	150
	Side (mm)	5	5	5	5	5	5
	Bottom (mm)	150	150	150	150	150	150
	Front (mm)*	600	600	600	600	600	600
User Interface	User display	2 Digit LCD	2 Digit LCD	2 Digit LCD	2 Digit LCD	2 Digit LCD	2 Digit LCD
	Diagnostics	Advanced	Advanced	Advanced	Advanced	Advanced	Advanced
	User adjustable CH temp control	Yes	Yes	Yes	Yes	Yes	Yes
	Optional inbuilt timer	No	No	No	No	No	No
Pipes	Water connections	2 x 22mm	2 x 22mm	2 x 22mm	2 x 22mm	2 x 22mm	2 x 22mm
	Max horizontal	8m	8m	8m	8m	8m	8m
Flues	Max vertical	8m	8m	8m	8m	8m	8m
	Max twin flue (total air + flue)	20m	20m	20m	20m	20m	20m
	Max direct rear flue	0.55m	0.55m	0.55m	0.55m	0.55m	0.55m
	Optional Plume Management Kit	Yes	Yes	Yes	Yes	Yes	Yes

\* This can be reduced to 5mm for removable panel

## Specifications : sx

Flexicom :	18sx	30sx	
<b>Size</b>	Casing dimensions (h w d)(mm)	700 x 390 x 280	700 x 390 x 280
	Weight (lift)	36kg	36kg
<b>Performance</b>	CH output (kW) Min/Max	9.3/18.0	9.3/30.0
	CH condensing Max output (kW)	18.8	31.0
	SEDBUK rating	A	A
	SEDBUK %	90.3	90.1
	NOx class 5 (natural gas)	Yes	Yes
	Adjustable to LPG	No	No
<b>Construction</b>	Main heat exchanger type	Cast	Cast
	Heat exchanger material	Aluminium	Aluminium
	Burner type	Pre-mixed	Pre-mixed
	Fully modulating	Yes	Yes
<b>Installation</b>	Suitable for sealed systems	Yes	Yes
	Suitable for open-vent systems	No	No
	Inbuilt system bypass	Yes automatic	Yes automatic
	Inbuilt condensate trap/siphon	Yes	Yes
	Inbuilt boiler frost protection	Two stage	Two stage
	'Continua' electronics	Yes	Yes
	Zero compartment ventilation	Yes	Yes
<b>Clearances</b>	Top (mm) (from top of boiler)	150	150
	Side (mm)	5	5
	Bottom (mm)	150	150
	Front (mm)*	600	600
<b>User Interface</b>	User display	2 Digit LCD	2 Digit LCD
	Diagnostics	Advanced	Advanced
	User adjustable CH temp control	Yes	Yes
	Optional inbuilt timer	No	No
<b>Pipes</b>	Prefixing jig with DIN layout	Yes	Yes
	Optional spacing frame	Yes	Yes
	Water connections	2 x 22mm	2 x 22mm
<b>Flues</b>	Max horizontal	8m	8m
	Max vertical	8m	8m
	Max twin flue (total air + flue)	20m	20m
	Max direct rear flue	0.55m	0.55m
	Optional Plume Management Kit	Yes	Yes

\* This can be reduced to 5mm for removable panel

## Cylinders : single coil

Cylinder sizes : 115 | 150 | 175 | 200 | 250 | 300

	115	150	175	200	250	300
Standard capacity litres	115	150	175	200	250	300
Maximum water supply pressure bar	10	10	10	10	10	10
Maximum primary circuit pressure bar	2.5	2.5	2.5	2.5	2.5	2.5
Pressure reducing valve bar	3.5	3.5	3.5	3.5	3.5	3.5
T/P valve °C/bar	95/7.0	95/7.0	95/7.0	95/7.0	95/7.0	95/7.0
Net weight (kg)	28	30	33	39	44	49
Weight (full) (kg)	145	175	205	245	310	340
Height (mm)	969	1179	1399	1499	1789	2109
Diameter (mm)	550	550	550	550	550	550

### Cylinder Connections

Cold mains inlet	22mm compression
DHW outlet	22mm compression
Balanced pressure cold water outlet	22mm compression
Primary flow	22mm compression (on 2 port valve)
Primary return	22mm compression
Electrical connections	230/240V,50Hz

### Coil Specifications

Reheat time min	18	20	18.5	24	28	42
Heat up time min	20	21	24	26	30	35
kW Coil rating	19.3	19.3	22	22	26	26
Heat loss kWh/24hrs	1.7	1.9	2.0	2.1	2.3	2.5

## Cylinders : twin coil

Cylinder sizes : 200 | 250 | 300

### Dimensions & Weights

Diameter (mm)	550	550	550
Height*	1499	1789	2109
Length of the immersion heater (mm)	430	430	430
Weight empty / full (kg)	39 / 245	44 / 310	49 / 340

### Performance

Capacity (l)	200	250	300
Reheat capacity (boiler) (%)	63	63	60
Heat up time (boiler) (mins)	21	26	30
Recovery time (boiler) (mins)	13	16	21
Heat loss (kWh/24hrs)	1.9	2.1	2.4

### Safety

Max mains inlet pressure (bar)	10	10	10
Pressure reducing valve setting (bar)	3.5	3.5	3.5
Expansion relief valve setting (bar)	6.0	6.0	6.0
T&P relief valve settings (°C / bar)	95 / 7.0	95 / 7.0	95 / 7.0

### Connections

Mains inlet / hot water outlet ** (mm)	22	22	22
Balanced cold water outlet** (mm)	22	22	22
Boiler flow / return** (mm)	22	22	22
Solar flow / return** (mm)	22	22	22
Thermostats & thermal cut outs [V (Hz)]	240V (50Hz)	240V (50Hz)	240V (50Hz)
Immersion heater & motorised valve [V (Hz)]	240V (50Hz)	240V (50Hz)	240V (50Hz)

\* Excluding clearances for connecting fittings / pipework

\*\* Compression fittings supplied

# Market leading customer care

MARKET LEADING SALES SUPPORT FROM GLOW-WORM



## Service Support

As a Glow-worm installer we will always support you and your customer with technical help and after sales support, online, over the phone and on the road, 7 days a week, 364 days a year, throughout the installation and life of the appliance.

All Glow-worm products are designed to exacting industry standards, are individually tested to ensure reliability and come with 2 years parts and labour free warranty as standard with extended warranty options available.

All our service engineers are Gas Safe registered and fully trained on all Glow-worm models past and present. There are 230 engineers based across the UK, each carrying over 1,500 different spare parts in their van enabling them to achieve an outstanding 97% first time fix rate. Alternatively, if you want standard technical information such as installation manuals and flueing information and don't want to spend time on the phone, visit our website at [www.glow-worm.co.uk](http://www.glow-worm.co.uk) where

you will find comprehensive technical information, solutions to common installation and system problems and advice on energy saving.

## Market leading spare part support

When you install a Glow-worm boiler, you can be confident that it has been manufactured to the highest of standards with tried and tested components. If in the unlikely event a problem occurs and a spare part is needed, then you can rest assured that Glow-worm's market leading spare parts division will have the item you require. Thanks to our commitment towards maintaining functional spare parts, availability is for up to 15 years after the range production ends. Glow-worm has a nationwide network of over 30 key spares stockists at approximately 450 locations around the UK which means getting hold of the part is as convenient as possible. If for any reason the item is not held by the stockist, then Glow-worm offers a next day delivery service for emergency orders.

Simply call the following numbers for the service you require:

**Technical Advice: 01773 828300**

**After Sales Service: 01773 828100**

**Spare Parts: 01773 596188**

The Glow-worm Service Centre lines are open: Monday to Friday 8:00am to 6:00pm, Saturday 9:00am to 4:00pm and Sunday 9:00am to 12:00pm.  
Technical Support lines are open: Monday to Friday 8:30am to 5:30pm and Saturday 9:00am to 12:00pm

# Our training courses

TRAINING CENTRES ACROSS THE UK

With so many changing regulations and new products, Glow-worm know how difficult it can be keeping up to date with all the information so that you can talk with knowledge and confidence to your customers and feel like you really understand the products you are working with. This is why Glow-worm provide hands-on training courses on all our product ranges and the latest regulations.

All training takes place at our specialist training centres around the country so you get expert training with minimum time taken off the job. Glow-worm training is delivered by fully qualified practitioners in a relaxed and informal environment supported by full reference materials and technical data sheets which you will take away with you and we won't let you go hungry as lunch and all refreshments are provided.

If it's training on domestic boilers you require then Glow-worm offer in-depth product training for both the Ultracom and the Flexicom ranges, along with Energy Efficiency for Domestic heating if you are just starting out.

If you are keen to turn your hand towards fitting renewable solutions, Glow-worm offers either a one-day Clearly Solar product training course if you are already solar accredited and want specific training on the Glow-worm range, or a two-day hands on Solar BPEC course which will give you a recognised solar accreditation upon completion.

If you are looking at attending a Solar BPEC course, then it's mandatory to complete a G3 unvented cylinder course first. This one-day course provides you with thorough understanding and a certified qualification to install and service unvented cylinders.

## Training centres

Fife	●	Caerphilly	●
Glasgow	●	Bristol	●
Elland (Near Leeds)	●	Exeter	●
Belper (Near Derby)	●	Sittingbourne	●
Norwich	●		

● Boiler System Training Centres ● Boiler System & Clearly Solar Training Centres

## Training courses

	Ultracom Product range	Flexicom Product range	Energy Efficiency for Domestic Heating
Duration	1 Day	1 Day	1 Day
Type of qualification	Manufacturer approved training	Manufacturer approved training	Certificate in Energy Efficiency for Domestic Heating
Course overview	Full training on the Glow-worm Ultracom range of high efficiency condensing boilers	Full training on the Glow-worm Flexicom range of high efficiency condensing boilers	Up-to-date information and training on technical system design, installation and regulations
Price	£35.25 per person inc vat	£35.25 per person inc vat	£141 per person inc vat

	Clearly Solar Product Training	Solar BPEC Course	G3 unvented cylinder training
Duration	1 Day	2 Days	1 Day
Course overview	A basic course giving insight into solar thermal theory, systems and products. What considerations you have to give to solar whether you are an installer, specifier or merchant.	2 day intensive, hands on course providing in-depth training on all domestic solar thermal systems including roof work. The course is certified through an examination at the end of the two days providing you with a recognised solar accreditation.	G3 is a mandatory qualification that you must hold when installing unvented cylinders (single or twin coil). Glow-worm provide a 1 day course, at the end you will be fully qualified to work with unvented cylinders. A G3 unvented qualification must be held before taking a BPEC course.
Price	£35.25 per person inc vat	£411.25 inc vat	£158.60 inc vat

For more information on Glow-worm training courses please contact:

Training: 01773 596156 | Email: [training@glow-worm.co.uk](mailto:training@glow-worm.co.uk) | Web: [www.glow-worm.co.uk](http://www.glow-worm.co.uk)

The information in this brochure was correct at the time of going to print. Glow-worm reserve the right to make any modifications to product specifications, or any other details, without prior notification. For further clarification, please enquire in writing to the head office address on the reverse of this brochure.

Head Office 01773 824639  
Literature 01773 596105  
After Sales Service 01773 828100  
Technical Advice 01773 828300

# Glow•worm

Nottingham Road, Belper, Derbys. DE56 1JT.

[www.glow-worm.co.uk](http://www.glow-worm.co.uk)



INVESTOR IN PEOPLE